



Compatible With
TTLock APP



works with the
Wechat applet



works with the
Google Home



works with the
amazon alexa



DS-L800F Smart Door Lock

Opening Methods



Mifare Card



Fingerprint



Password



APP (Bluetooth)



Remote Control



Mechanical Key

- DS-L800F fingerprint door lock with semiconductor fingerprint head, which is an intelligent and convenient door entrance solution.
- Unlock using your smart phone, change pin-codes and download unlocking records from the TTLock App.
- The lock body is made of Stainless Steel +Metal Panel which is smooth, beautiful, anti-rust and durable.
- The lock is powered with Long Lasting Batteries, up to 4 standard batteries can be installed, effectively powering the lock for 12 months. It doesn't need any external power source.
- In case of low power, the USB port can support for temporary charge to open the door and please replace a new battery.
- DS-L800F suitable for inward and outward opening doors of a thickness between 38-55mm.

Features

- Anti-theft mortise with one latch and one security deadbolts.
- Various accesses for your convenience –Fingerprint/ Mifare Card/ Touch Screen Pin-code/ Mechanical Key/ Bluetooth & App.
- Mobile phone management multilingual support.
- Support voice guide in English.
- Illuminated e-touch keypad for easy operations in the dark.
- With random password feature for higher security, secure your passcode from prying eyes.
- Smart alarm for low battery / illegal operation.
- LED indicator and inbuilt buzzer.
- Wi-Fi remote control to open door is optional.

Product Details

Model No.	DS-L800F
Framework Material	Zinc Alloy+304 stainless steel
Mortise	China Standard Anti-theft Mortise
Identification Mode	Fingerprint, Smart Phone, Mifare Card , Passcode
Fingerprint Capacity	100
Fingerprint Sensor	Semi-conductor (silicon)
Password Capacity	150(for custom),Unlimited(for App send)
Card Capacity	200
Card Module	M1(13.56 MHz)
Backup Power Interface	Micro-USB Port Supported
Wireless Module	BLE4.1
Remote Access	Bluetooth Gateway Required
App Language	Multilingual Support
Operating Temperature	-20°C - 70°C
Batteries	4xAA alkaline battery (NOT supplied)
Battery Life	Over 10000 times (above 1 year)
Door Thickness	38-55 mm
Dimensions	Front Panel - 77(W)×310(L)×30(D) mm
	Back Panel - 77(W)×310(L)×30(D) mm
Packaging Weight	3.6kg
Color Type	Silver/Antique Copper/ Antique Brass / Black

Dimensions (mm)

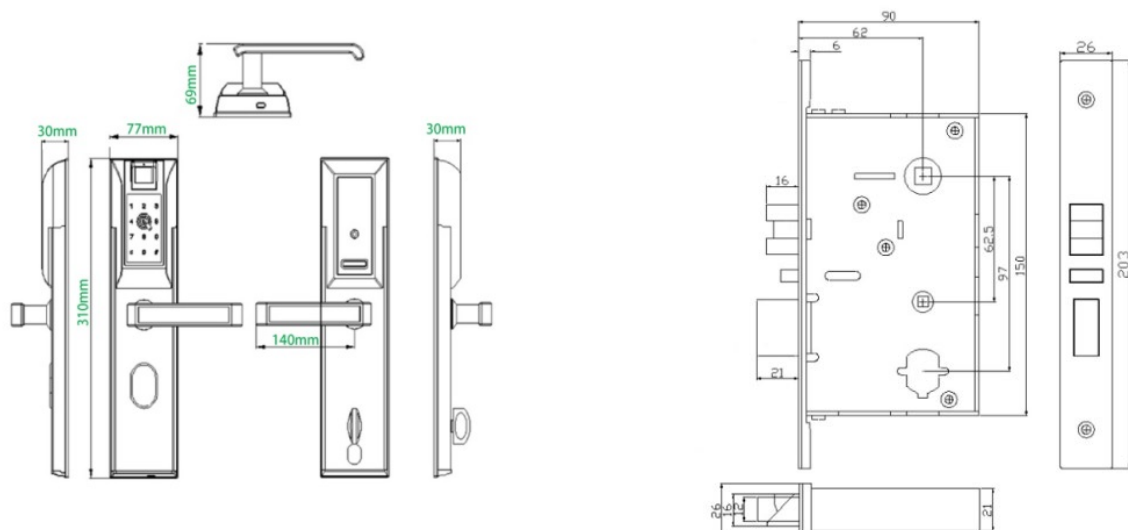

Bluetooth Lock Working Principle



Mobile Application



For Android



For Apple iOS

Application Scenarios



Short-rent Apartments



Detached House

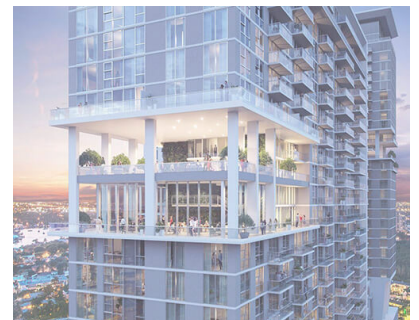

Modern High-rise Apartments