



Compatible With
TTLock APP



works with the
Wechat applet



works with the
Google Home



works with the
amazon alexa



DS-L500 Bluetooth Lock



Opening Methods



Mifare Card

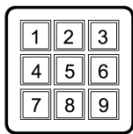

Password



App (Bluetooth)



Remote Control



Mechanical Key

- DS-L500 Bluetooth & App Smart Lock is a modern and compact stylish lock that features Pin code and Bluetooth access to unlock the door.
- Unlock using your smart phone, change pin-codes and download unlocking records from the TLock App.
- The lock body is made of Zinc Alloy+ Acrylic Panel which is smooth, beautiful, anti-rust and durable.
- The lock is powered with Long Lasting Batteries, up to 4 standard batteries can be installed, effectively powering the lock for 12 months. It doesn't need any external power source.
- In case of low power, the mechanical keys can open the door and please replace a new battery.
- The lock suitable for inward and outward opening doors of a thickness between 35-55mm.

Features

- Easy Installation ideal upgrade or replacement for existing ball door locks directly.
- Reversible design to accommodate all door open directions easily changed for right or left hand opening doors.
- Various accesses for your convenience –Mifare Card/ Touch Screen Pin-code/ Key/ Bluetooth & App.
- Illuminated e-touch keypad for easy operations in the dark.
- With random password feature for higher security, secure your passcode from prying eyes.
- Smart alarm for low battery / illegal operation.
- M1 (13.56 MHz) IC card reader is standard.
- Wi-Fi remote control to open door is optional.

Product Details

Model No.	DS-L500
Framework Material	Zinc Alloy+304 stainless steel
Mortise	American Standard Single Latch German Standard Mortise (optional)
Identification Mode	Smart Phone, Mifare card, Passcode
Password Capacity	150
Card Capacity	200
Card Module	M1(13.56 MHz)
Wireless Module	BLE4.1
Remote Access	Bluetooth Gateway Required
Operating Temperature	-20°C - 70°C
Batteries	4xAA alkaline battery (NOT supplied)
Battery Life	Over 10000 times (above 1 year)
Door Thickness	35-55 mm
Backset	Adjustable 60 or 70 mm (only for single latch)
Dimensions	Front Panel - 68(W)×168(L)×25(D) mm
	Back Panel - 68(W)×168(L)×25(D) mm
Packaging Weight	3kg
Color Type	Gold/Silver/Antique Copper/ Antique Brass /

Dimensions (mm)

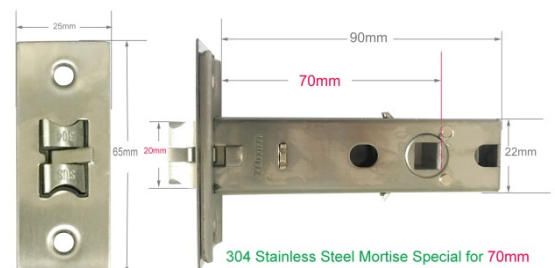
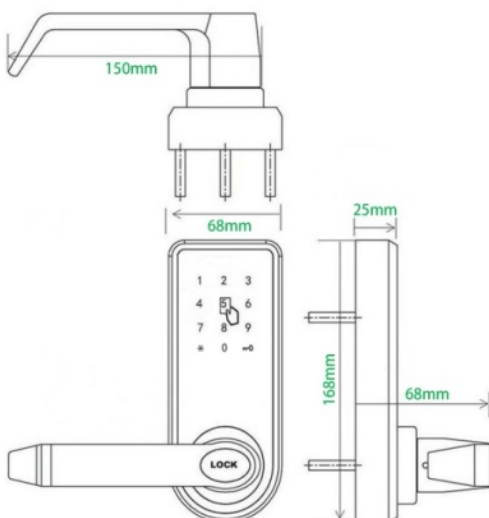

Bluetooth Lock Working Principle

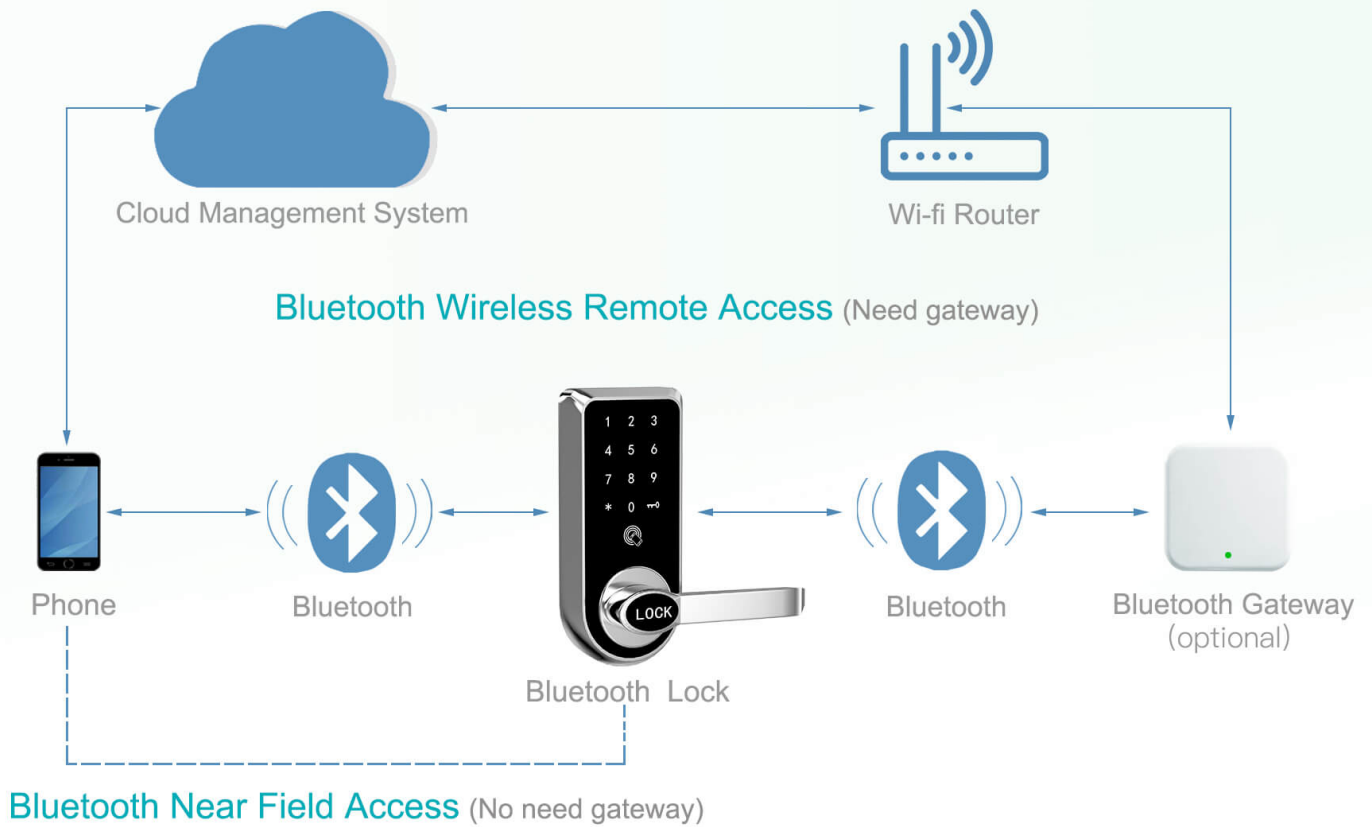

Mobile Application



For Android



For Apple iOS

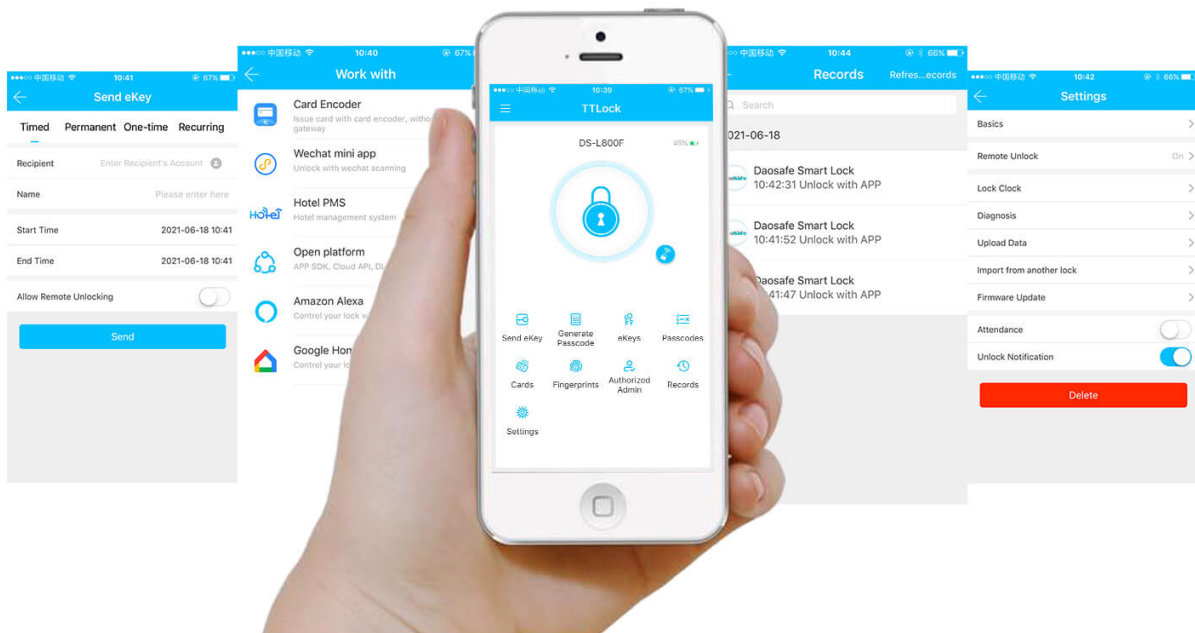

Replacement for Existing Ball Door Lock

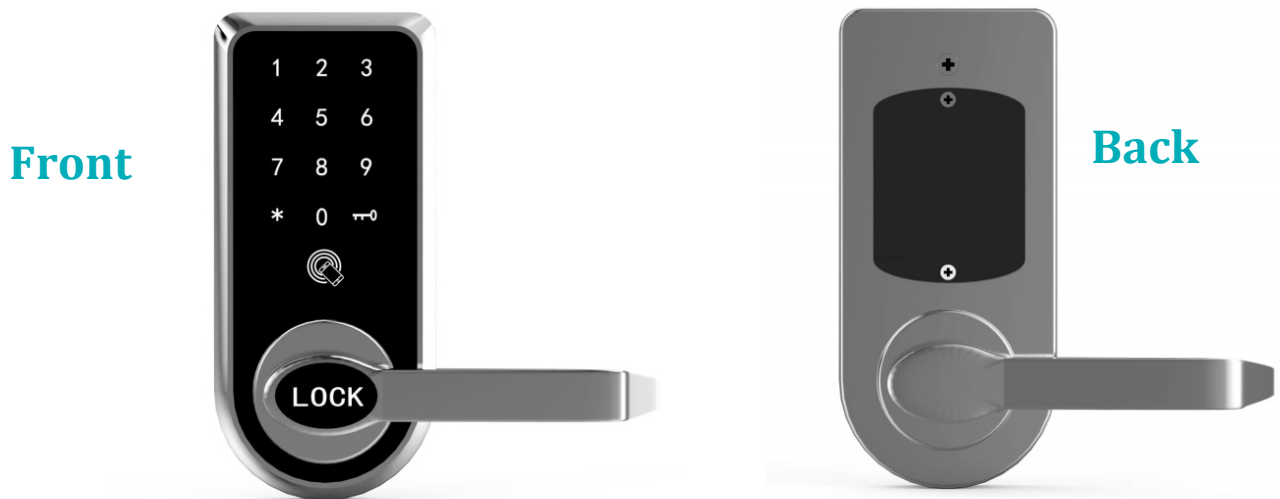

Application Scenarios



Short-rent Apartments



Detached House

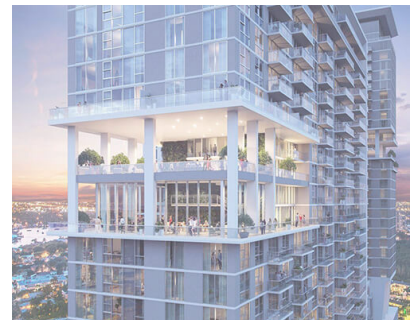

Modern High-rise Apartments