



DS-L300H Hotel Door Lock

Opening Methods



ID or Mifare Card



Mechanical Key

- DS-L300H Hotel lock is a multipurpose lock which is intelligent and convenient door entrance solutions.
- The body is made of Zinc Alloy which is Beautiful stylish, anti-rust and durable.
- The lock is powered with Long Lasting Batteries, up to 4 standard batteries can be installed, effectively powering the lock for 12 months. It doesn't need any external power source.
- In case of low power, the mechanical keys can open the door and please replace a new battery.
- The lock can be suitable used for: Detached house/Apartment building/Businesses office/Home / Residential/Government / Aged care and so on.

Features

- Anti-theft mortise with one latch and one security deadbolts
- Automatic locking function
- Intelligent authorization management system
- Smart alarm for low battery / illegal operation
- (T5557)125khz ID card is standard, (M1)13.56MHz card is optional
- Including free Card Lock Management Software System

Product Details

Model No.	DS-L300H
Framework Material	Zinc Alloy+ 304 stainless steel handle& lock body
Mortise	China Standard Anti-theft Mortise
Identification Mode	ID or Mifare card
Card Capacity	200
Card Module	125khz ID card (standard), M1(13.56 MHz optional)
Operating Temperature	-20°C - 70°C
Batteries	4xAA alkaline battery (NOT supplied)
Battery Life	Over 10000 times (above 1 year)
Door Thickness	35-55 mm
Packaging Weight	3.2kg
Dimensions	Front Panel - 70(W)×298(L)×20(D) mm
	Back Panel - 70(W)×298(L)×20(D) mm
Color Type	Silver/Gold / Black

Dimensions (mm)

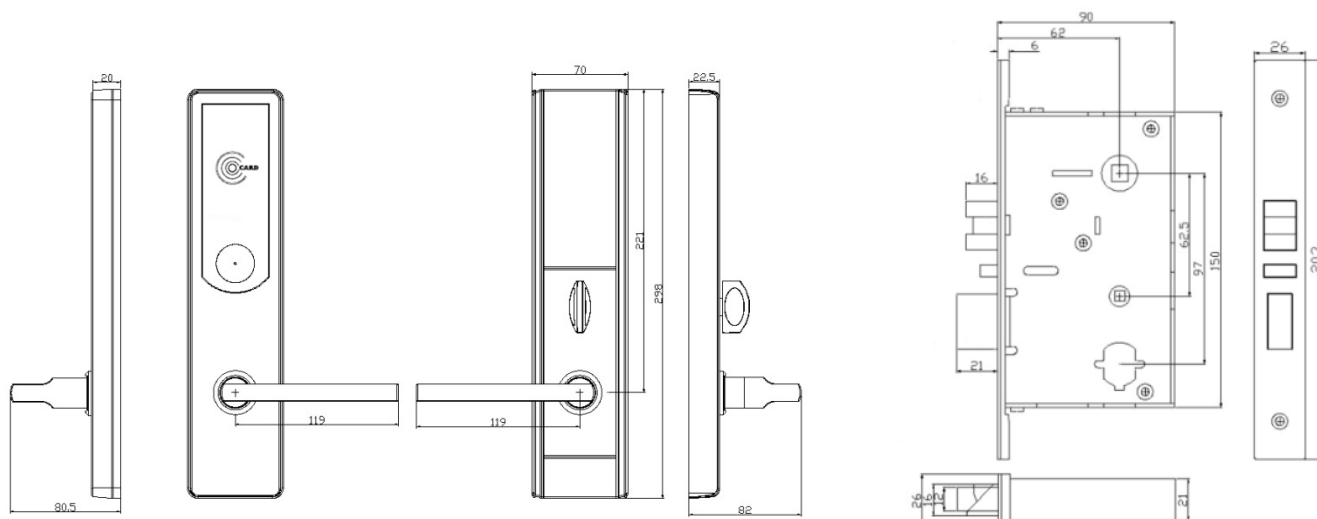

Hotel Door Lock Working Principle

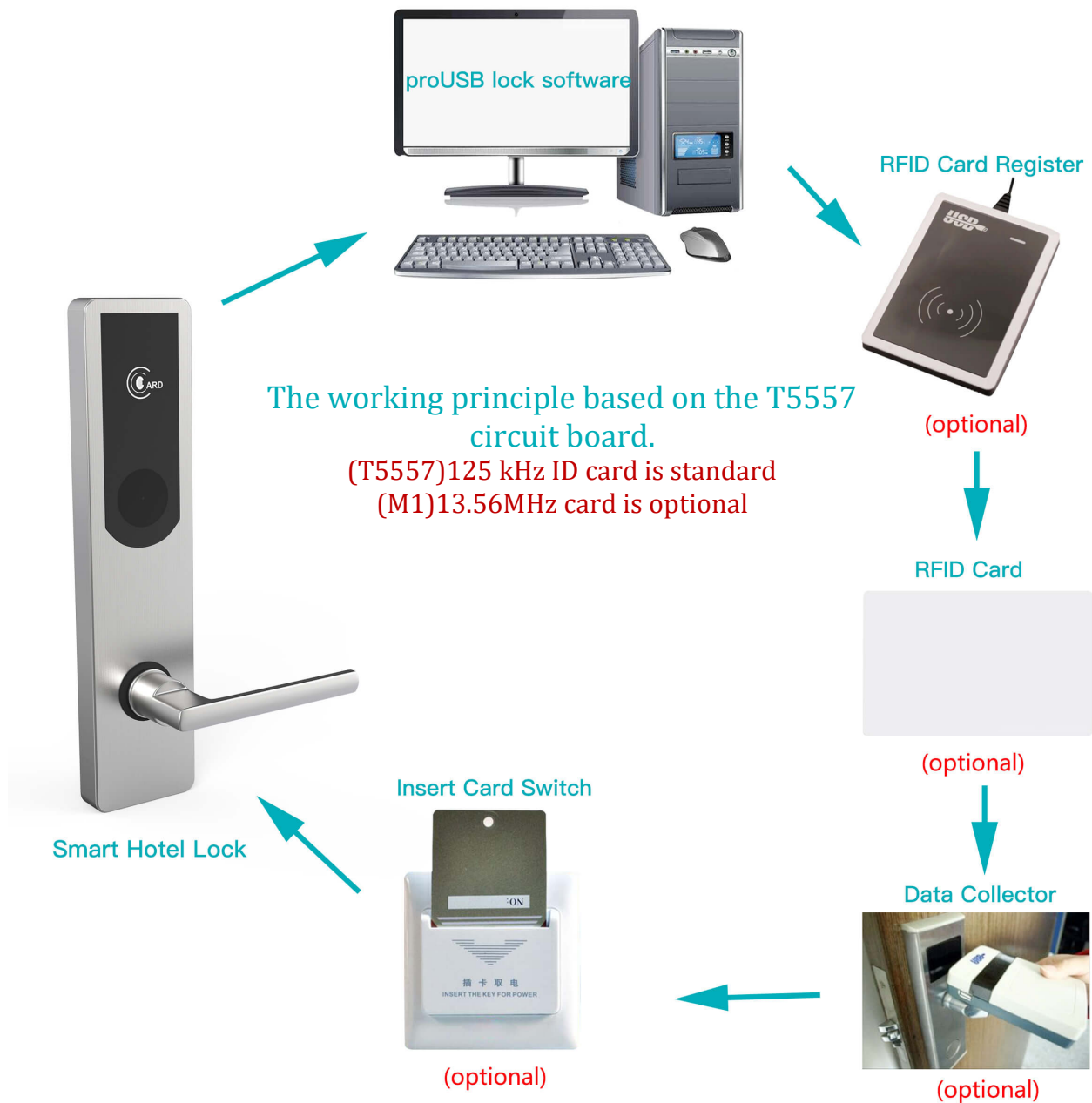

Application Scenarios



Short-rent Apartments



High-end Hotel

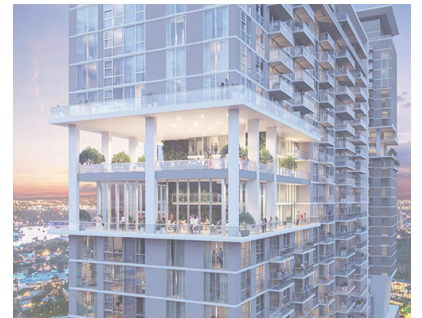

Modern High-rise Apartments